

## LOCK FOCUS AUSSIE TRAVELLER (AT) DC DOOR LOCK ADPATOR KIT

The Lock Focus AT DC Door Lock Adaptor Kit provides key convenience and security for your RV.

Providing a barrel exchange feature, the Lock Focus AT DC Door Lock Adaptor Kit is perfect for locking caravan doors to reduce the number of keys.

The Lock Focus AT DC Door Lock Adaptor Kit will operate with a range of Lock Focus exchange barrels, including the RV single key barrel.

### Required products/tools for installation:

- Aussie Traveller DC Door Lock
- Lock Focus Aussie Traveller DC Door Lock Adaptor Kit
- Lock Focus Exchange Barrel & matching Servant Key
- Lock Focus Exchange Key (red)
- Drill with 3mm drill bit
- Phillips No. 1 Screwdriver
- M4 Screw (or a sharp implement to remove grommets)
- Flathead Screwdriver
- Circlip Plier

## CHANGEOVER PROCEDURE

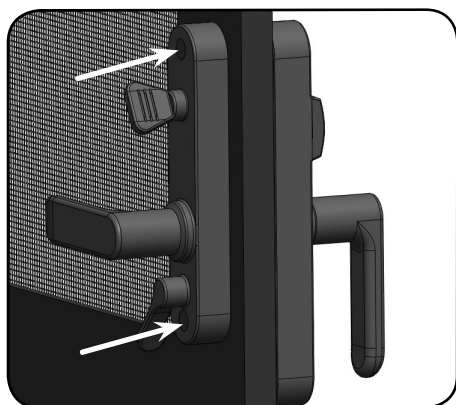

### 1. Locate Grommets

Open the door and remove the key. Proceed to release the outer door. Locate the grommets as illustrated in the diagram above.

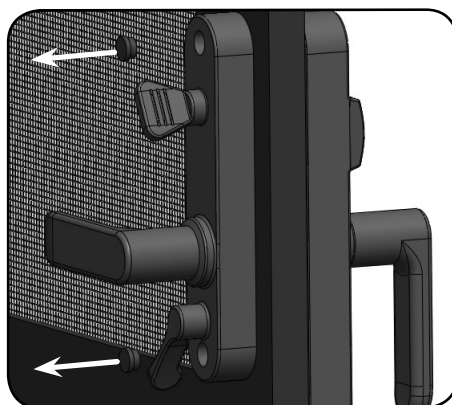

### 2. Remove Grommets

Using a drill, create 3mm holes in the grommets. Stop drilling once the grommets have been penetrated. Thread the M4 screws into the grommets (or use the sharp tool), then pull the grommets out.

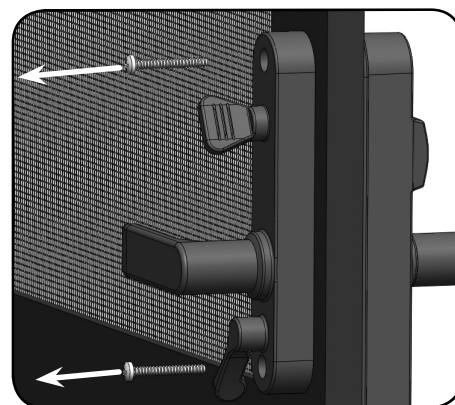

### 3. Remove Screws

After removing the grommets, screws will be visible. Use a Phillips No. 1 screwdriver to remove the screws. Hold both the front and back housing to prevent the parts from falling.

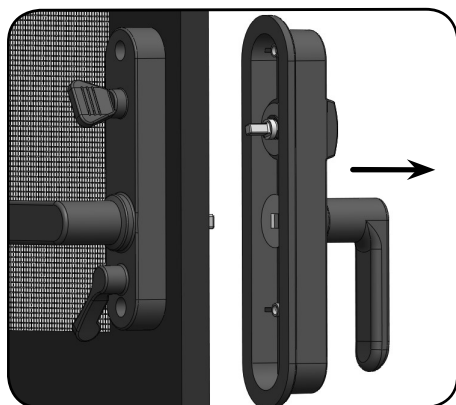

### 4. Remove Front Handle Assembly

Remove the front handle assembly while keeping the back handle assembly firmly in place.

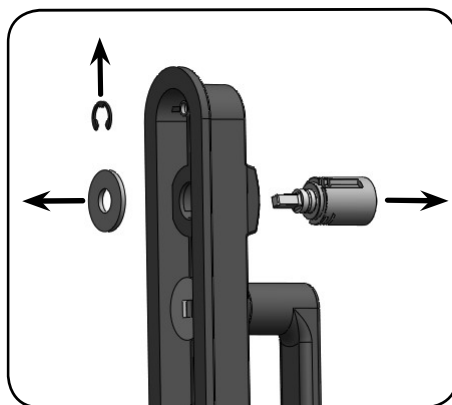

### 5. Remove Existing Lock Assembly

Use a flathead screwdriver to remove the circlip at the back. The washer and the existing lock assembly should then come out easily.

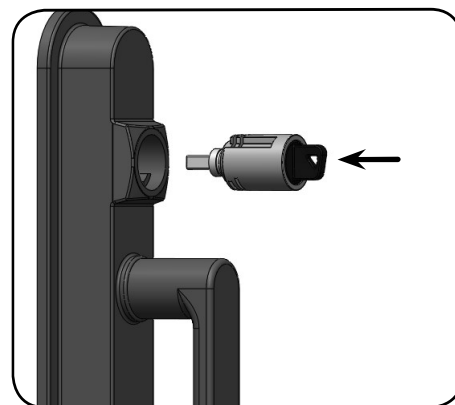

### 6. Insert Lock Focus AT DC Lock

Insert the Lock Focus AT DC Lock Adaptor Kit into the slot where the old lock was positioned.

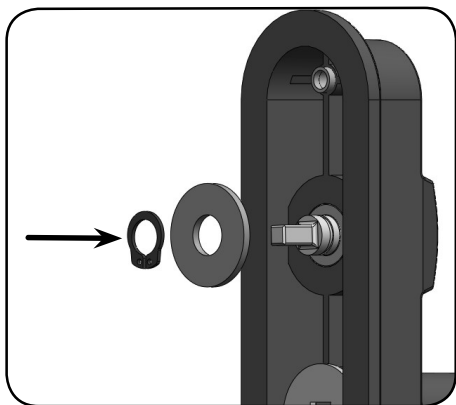

## 7. Insert Washer and Circlip

Place the existing washer onto the back of the Lock Focus AT DC Lock Adaptor Kit. Using a circlip plier, insert the supplied new circlip into the groove of the lock to secure it in place within the housing.

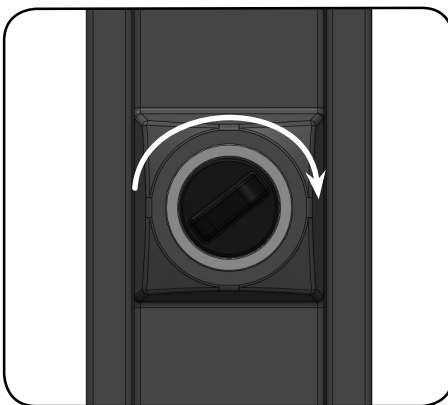

## 8. Remove Barrel Placeholder

Rotate the barrel placeholder to approximately the 2 o'clock position and pull it out. Adjust the placeholder's position until it can be easily removed.

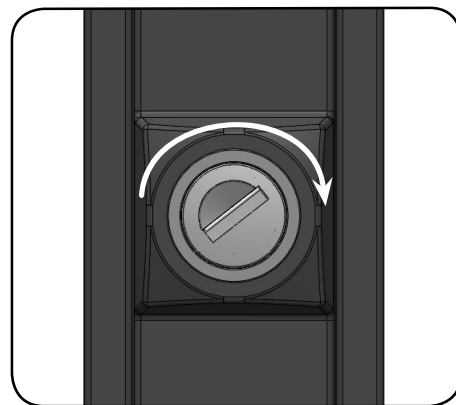

## 9. Insert Lock Focus Exchange Barrel

Insert the key into the Lock Focus Exchange Barrel. Position the barrel into the housing at approximately the 2 o'clock location where the barrel placeholder was removed. Once the barrel is inserted, remove the key in the 12 o'clock position.

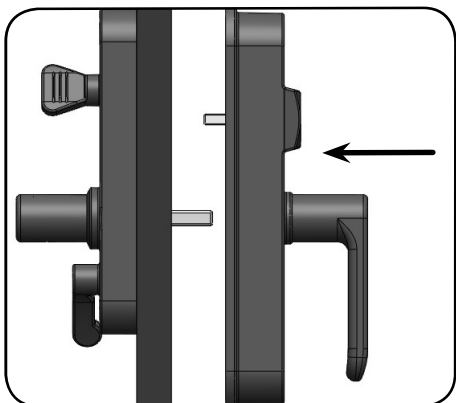

## 10. Replace Front Housing

Insert the front housing onto the door, making sure the back housing remains properly positioned. Align and carefully insert the cams of the front housing into the corresponding holes in the mortice latch.

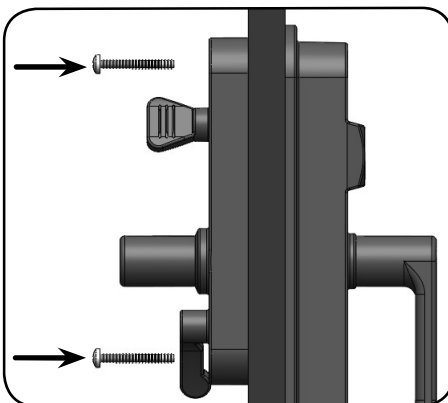

## 11. Replace Screws

Reinsert the screws that were previously removed. Tighten each screw until it is securely fastened.

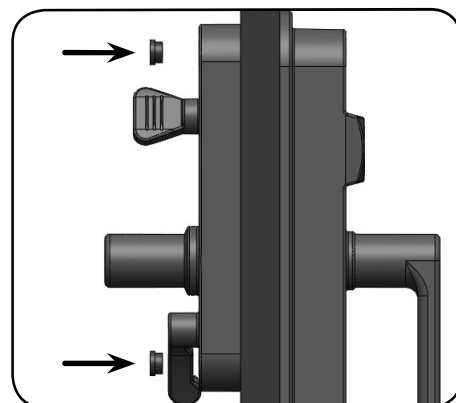

## 12. Replace Grommets

Insert the new grommets provided in the pack, making sure they are flat on the housing.

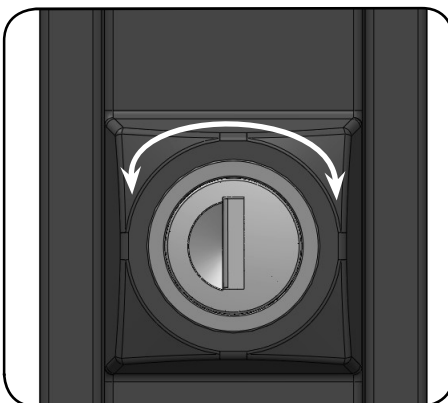

## 13. Test Lock Function

To test the lock, rotate the keys both clockwise and counterclockwise. Verify that the door locks and unlocks smoothly.